

4 MT Stainless Steel Olive Calibration Machine

4 MT Paslanmaz
Zeytin Kalibre Makinası

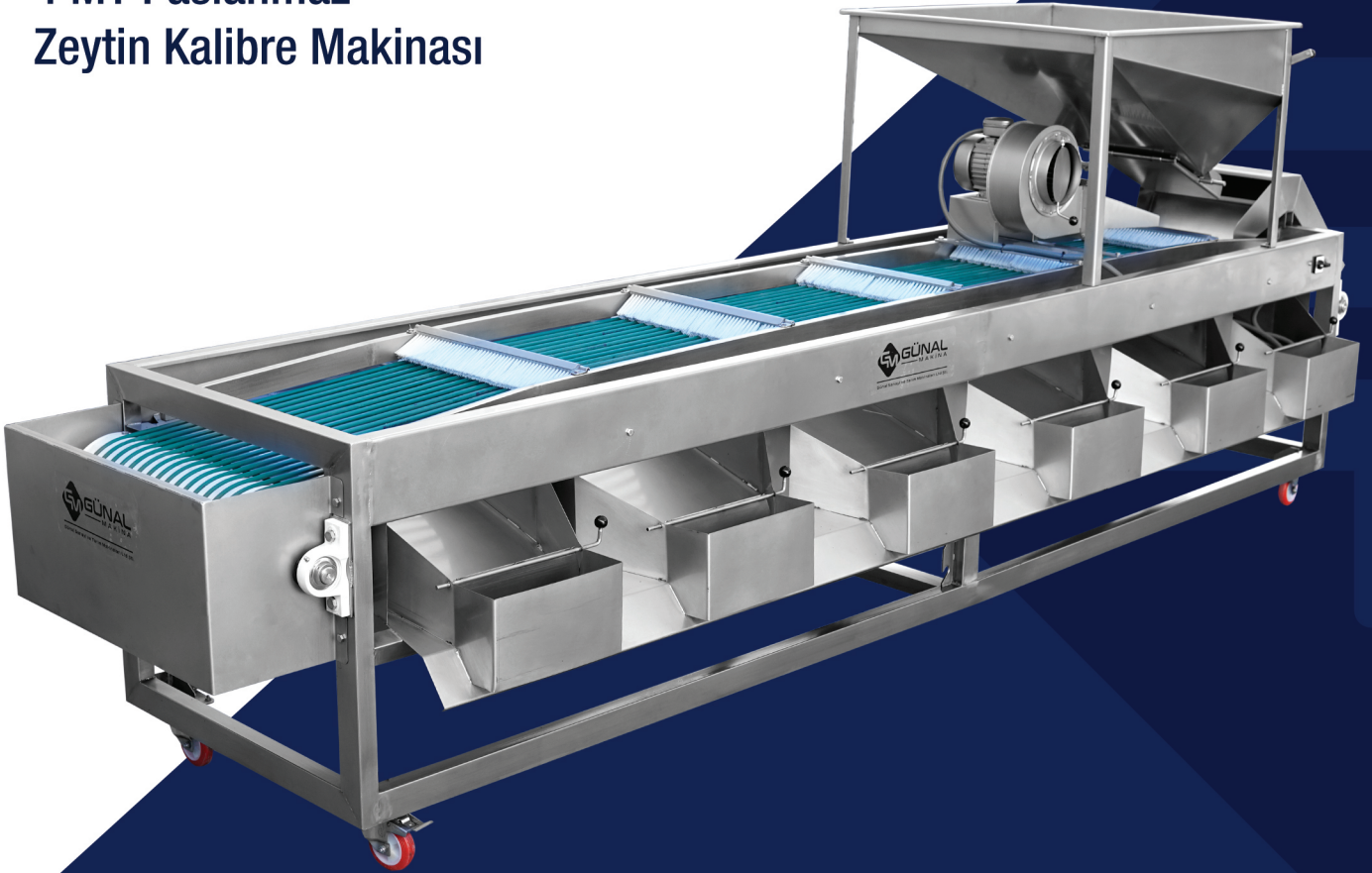

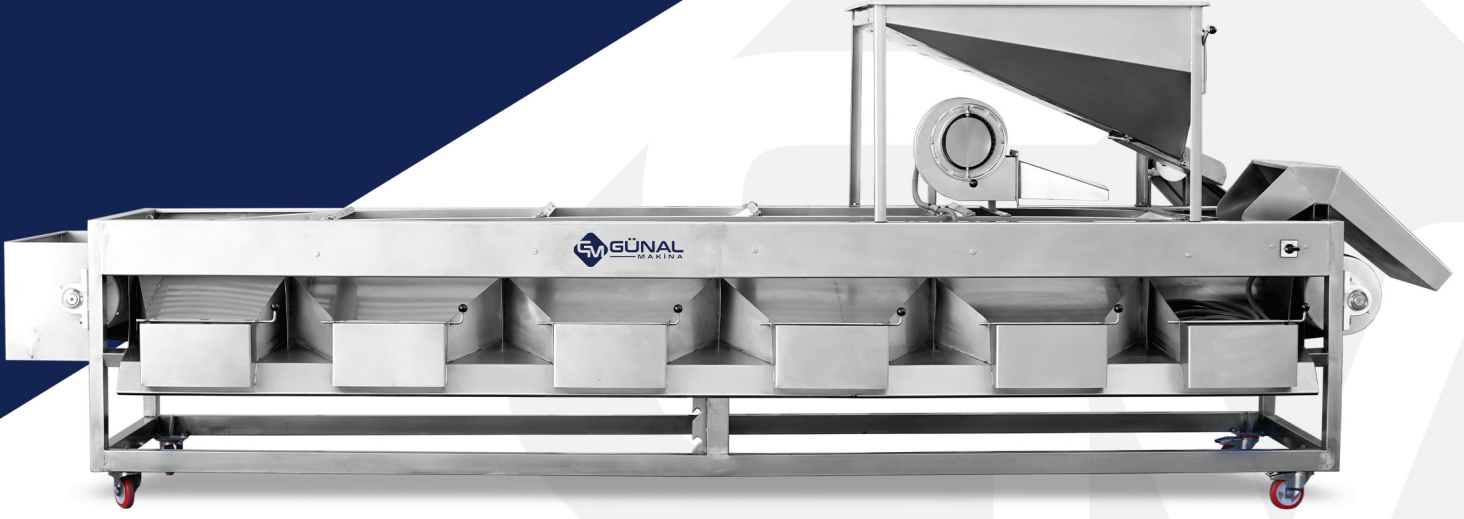

Model	GM104	GM106	GM108	GM1010
Kapasite (Capacity)	1500-2000 Kg/h	1750-2250 Kg/h	2000-2500 Kg/h	2250-2750 Kg/h
Kalibre Sırası (Cord No)	20 adet / piece	20 adet / piece	20 adet / piece	20 adet / piece
Kalibre İp Cinsi ve Çapı (Calibration Cord Type and Diameter)	10 mm PU Yuvarlak (10mm PU Poliurethane)	10 mm PU Yuvarlak (10mm PU Poliurethane)	10 mm PU Yuvarlak (10mm PU Poliurethane)	10 mm PU Yuvarlak (10mm PU Poliurethane)
Kalibre Göz Sayısı (Calibration Partition No)	6+1	8+1	10+1	12+1
Makine Hızı (Speed of Machine)	75 mt/dk/min	75 mt/dk/min	75 mt/dk/min	75 mt/dk/min
Motor Gücü (Source Power)	0,75 Kw + 0,37 Kw	0,75 Kw + 0,37 Kw	0,75 Kw + 0,37 Kw	0,75 Kw + 0,37 Kw

Technical Specifications

- Length x Width x Height: 4200 x 1050 x 1450 mm.
- Power: 0,55 Kw Geared Motor
- Fan Power: 0,37 Kw
- Calibration Cord No: 17 Line.
- Calibration Cord Type and Diameter: 10 mm PU Poliurethane.
- Calibration Partition no: 6+1 Fixed (not adjustable).
- Calibration Diameters for (olives): 12,5mm to 21,5mm.
- Hopper Volume: 120 Lt Hopper Volume.
- Material Quality: 304 Quality Stainless Steel.
- Capacity: 1500-2000 Kg/Hour
- Guaranty: Production faults cover 1 (ONE) warranty. User faults are out of warranty.

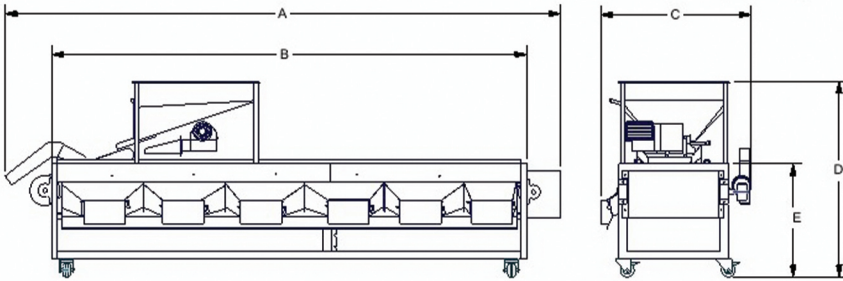

	A	B	C	D	E
GM 104	4200mm	3500mm	1100mm	1450mm	820mm
GM 106	6200mm	5500mm	1100mm	1450mm	820mm
GM 108	8200mm	7500mm	1100mm	1450mm	820mm
GM 1010	10200mm	9500mm	1100mm	1450mm	820mm

Teknik Özellikler

- Uzunluk x Genişlik x Yükseklik: 4200 X 1100 X 1450 mm
- Motor Gücü: 0,55 Kw Redüktör Motor
- Fan Motor Gücü: 0,37 Kw
- Kalibre Aralığı: 17 Sıra
- Kalibre Kayış'ı Tipi ve Kalınlığı: 10MM PU Yuvarlak Kayış
- Kalibre Bölme Aralığı: 6+1 Sabit Bölme
- Kalibre Aralığı: 12,5 MM – 21,5MM
- Hazne Hacmi: 120 Lt Hazne Hacmi
- Malzeme Kalitesi : 304 Kalite Paslanmaz Çelik.
- Kapasite: 1500-2000 Kg/Saat.
- Garanti : Kullanıcı Hataları Hariç 1 (BİR) yıl.